

Heysea Yacht Group Limited

Website: www.heyseayachts.com

Email: sales@heysea.com

HeySea

SEAVIEW 50

— Built by Heysea





SEAVIEW 50

— Built by Heysea



REDEFINED SAILING: LUXURY AND SUSTAINABLE

Seaview sailing catamaran stands out prominently on the global maritime stage, seamlessly blending Heysea's professional design prowess in the realm of super yachts with cutting-edge green technology solutions. Its objective is to deliver a quiet, luxury, and environmentally conscious sailing experience.

Different from other standardized catamarans, Heysea design team sets Seaview apart by prioritizing meticulous details and a profound understanding of how boat owners interact with their vessels. This commitment goes beyond external aesthetics, extending into carefully crafted internal spaces that cater to diverse needs. Whether sailing across expansive oceans or functioning as a vibrant social hub, Seaview excels in fulfilling a diverse range of purposes.

Seaview represents an unequivocal innovation, deserving admiration and enjoyment. Heysea guarantees that even the most discerning sailing enthusiasts will discover every desired element in the Seaview series. We eagerly anticipate the inclusion of more sailing enthusiasts in the journey of this groundbreaking creation, as they script their own maritime legends!

SEAVIEW 50

Built by Heysea





Solar cell panel
Powers essential onboard life

Autocruise System
Safe and comfortable driving

Windlass Cover
Safer to relax on the trampoline

Hydraulic Swim Platform

PROFILE VIEW

The Seaview 50 catamaran boasts impressive specifications, measuring 15.2 meters in length, 8.02 meters in beam, and featuring a draft of 1.5 meters.

With a generous main sail area of 80 square meters complemented by a 50-square-meter foresail, this vessel seamlessly merges modern maritime technology with timeless sailboat aesthetics. It excels in both stability and long-range sailing performance, making it well-suited for Class I navigation zones.

Additionally, optionally equipped with an automatic steering system operable by a single person and a 48KWH lithium iron phosphate energy storage battery catering to the electricity needs for air conditioning during 6-8 hours at night, the Seaview 50 stands out as a leader in its class.



FLYBRIDGE

The flybridge is a versatile outdoor space with a barbecue, dining table, and sun lounges, serving as a perfect dining and sunbathing area.

The solar panels (optional) installed on the hardtop can convert collected solar energy into electricity, providing power for the daily living needs on the catamaran.

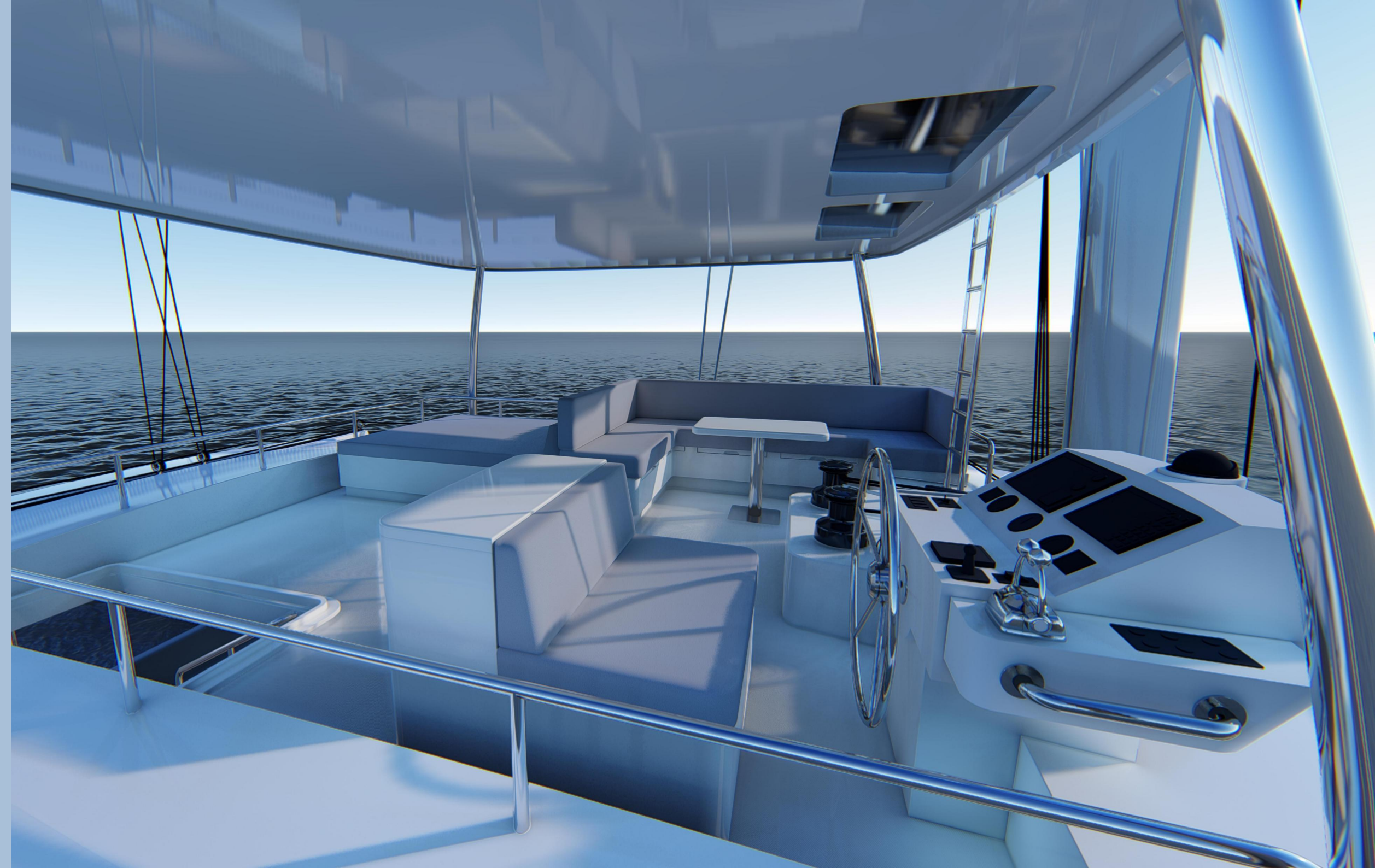

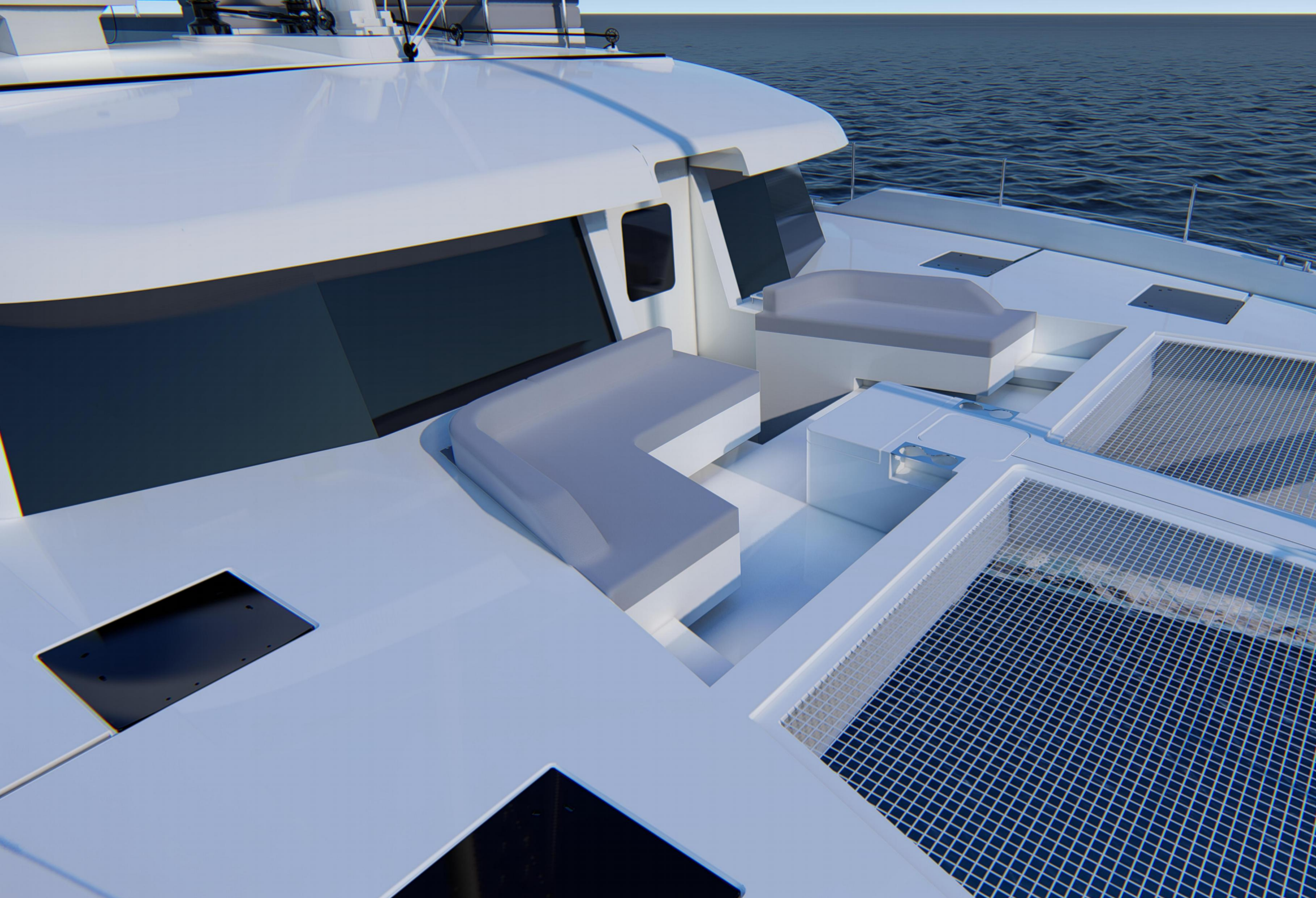

FOREDECK

The foredeck of Seaview 50 is equipped with a trampoline and features a fully enclosed anchor chain locker and a concealed anchor machine, ensuring a worry-free and exceptional sailing experience.

The design of the sunshade(optional) on the foredeck allows for seamless push-and-pull storage. When raised, it shields from direct sunlight, providing a refreshing sea breeze experience; when retracted, it minimizes outdoor space occupation, offering a panoramic view.

Additionally, this area is furnished with an open-air sea-view projection private cinema(optional) ,delivering an unparalleled visual indulgence.





AFTDECK

The aftdeck is equipped with sofa and table, providing comfortable seating for guests. The sliding kitchen window ensures seamless connectivity to the aft deck, allowing the owner to enjoy cooking while engaging with guests. The hydraulic swim platform (optional), serving as a flexible outdoor space, expands the social area when raised and integrates with the diving platform when lowered.





MAIN DECK

The salon of the Seaview 50 is embraced by expansive glass windows, allowing natural light to flood in from all directions. Dual-sliding glass doors at the front and rear encourage a seamless transition, enticing guests to explore the enchanting allure of the sea on both the foredeck and aftdeck. The open kitchen acts as a welcoming focal point, bringing friends and family together to enjoy cooking while engaging in social interactions.







LOWER DECK

The lower deck has spacious suites with comfortable beds, private bathrooms, and ample storage, meeting diverse needs. Meticulous design ensures efficient use of space, emphasizing both comfort and intricate details for a luxurious onboard experience.

The Seaview 50 is offered in two versions: a standardized leasing version and a customizable private ownership version, providing yacht owners with a range of layout options, including two-cabin, three-cabin, and four-cabin configurations.







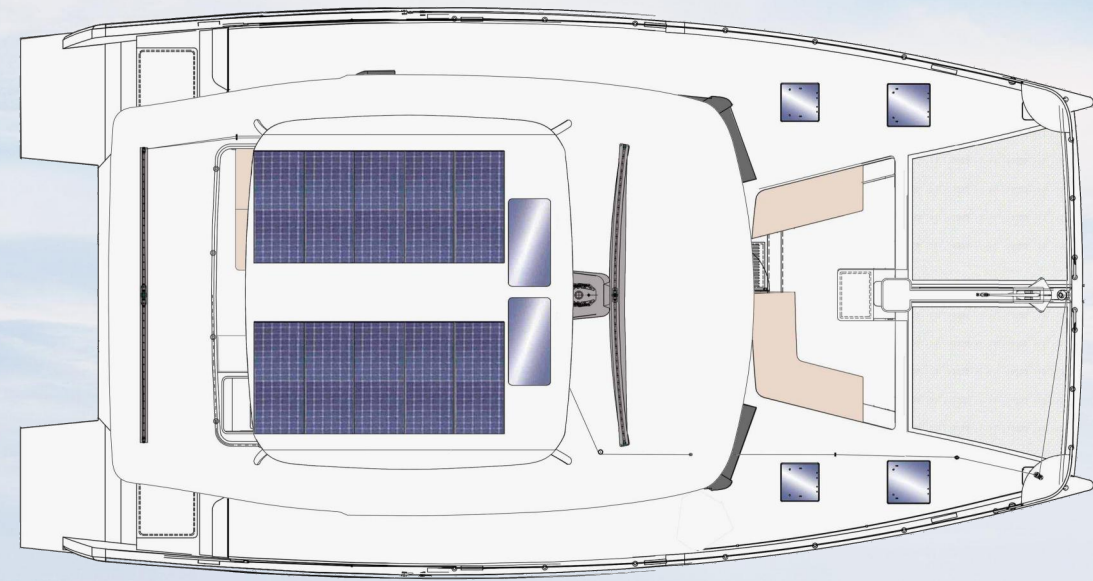

FLYBRIDGE



MAIN DECK



LOWER DECK

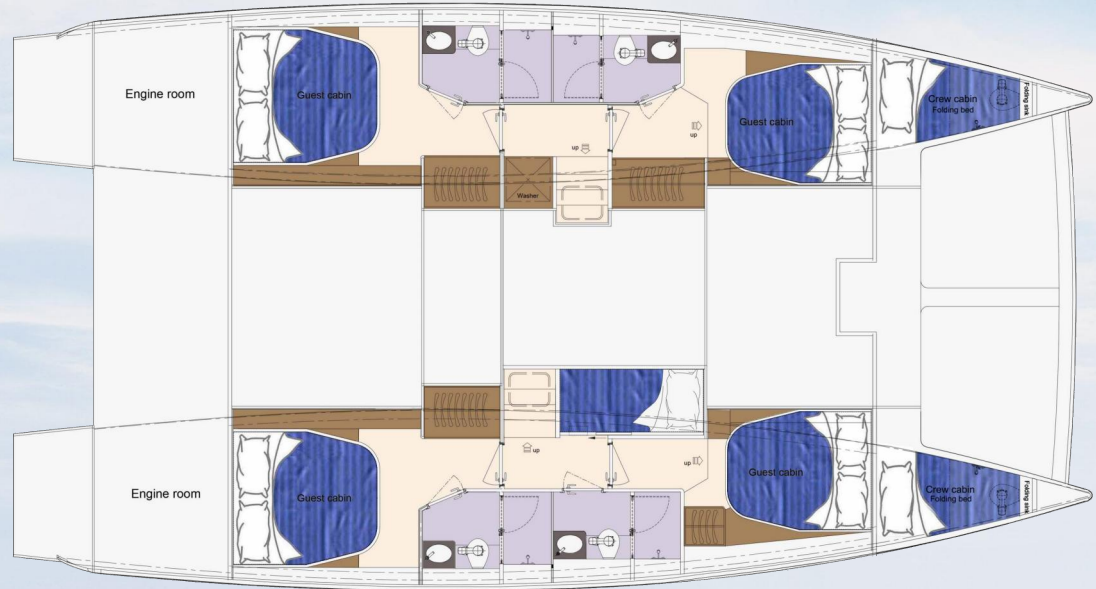

Charter Version:
4 Guest Cabins + 1 Crew Cabin

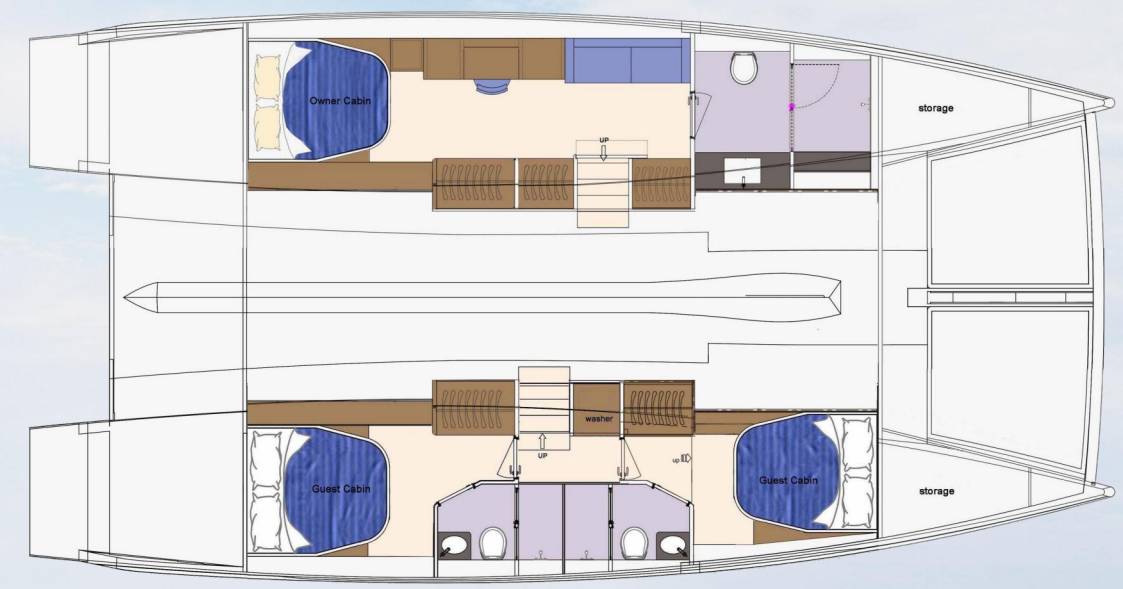

Owner Version B:
1 Owner Cabin + 2 Guest Cabins

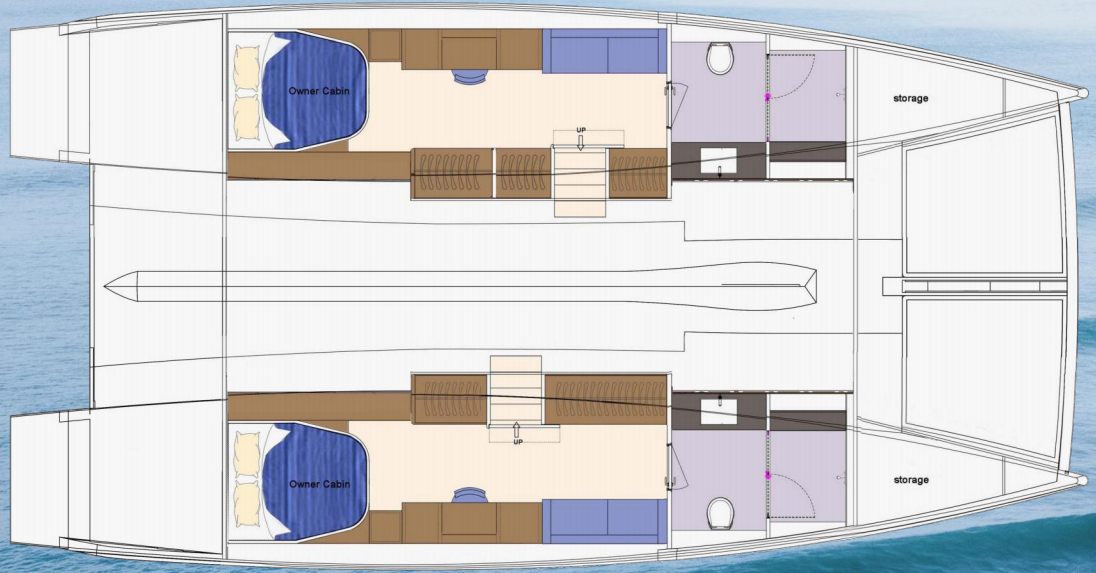

Owner Version A:
2 Owner Cabins

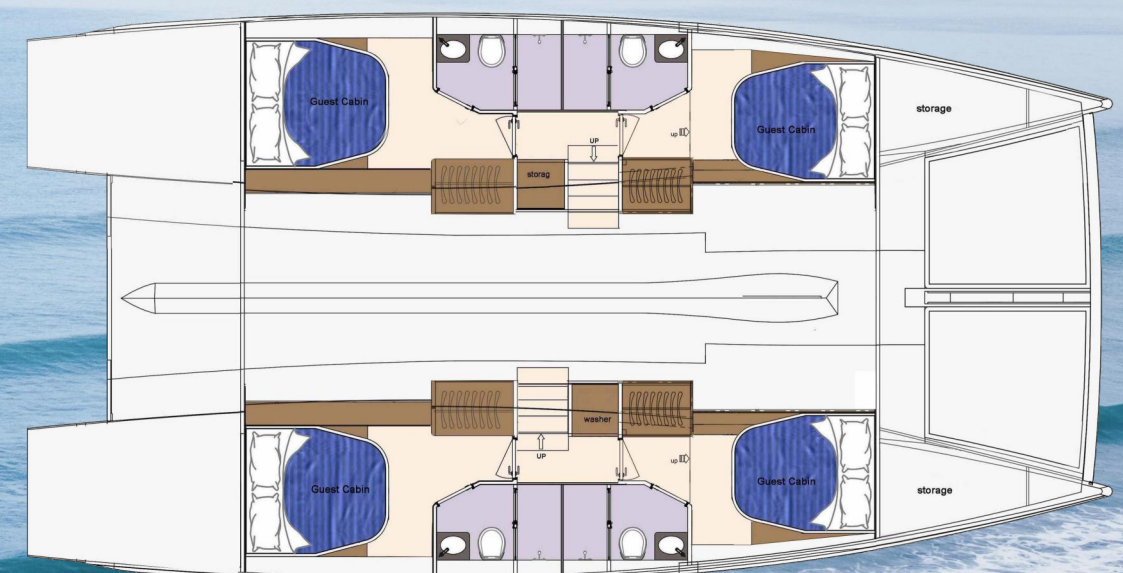

Owner Version C:
4 Guest Cabins

SEAVIEW 50

Built by Heysea

SPECIFICATION

Length Overall:	15.2M (50'0")
Length Hull:	14.7M (48'2")
Beam:	8.02M (26'3")
Draft:	1.54M (5'1")
Fuel Capacity:	2 x 500Ltrs (264 US Gal.)
Freshwater Capacity:	2 x 500Ltrs (264 US Gal.)
Mast Height above Waterline:	23M (75'5")
Main Sail Area (appr.):	80m ²
Jib Sail Area (appr.):	50m ²
Engine:	2 x VOLVO 50HP
Generators:	Kohler 13.5KW @ 50Hz
Speed with Engines:	8-10 Knots
Speed with Sails:	8-10 Knots
CE Certification:	A:14,B:18, C:30
Builder:	Heysea Yachts

